

Combo Jig

Roof

Wall

Floor

Sawing

Timber Jointing

Production Tools

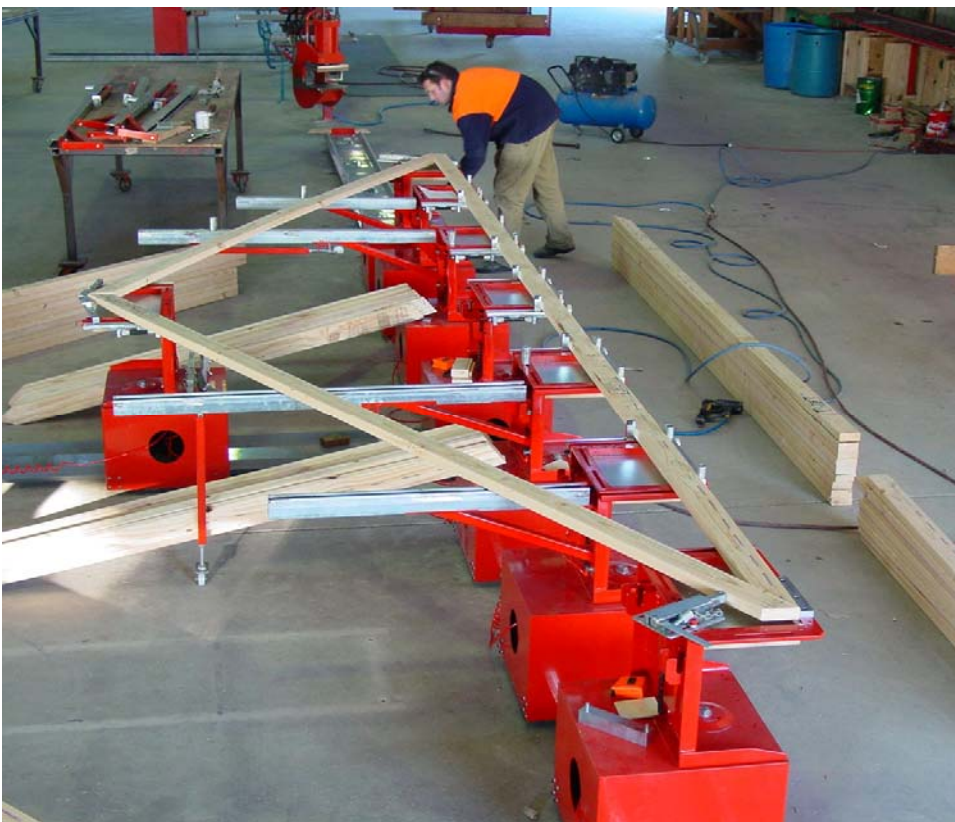

- Low profile floor rails to ensure easier operation
- All stations are fitted with wheels and air brakes for easy jig setting
- Bottom chord stations are fitted with quick camber adjustment
- Jig can include two apex stations for positive jiggling of complex roof trusses
- Heavy duty construction provides a long working life and accurate setting
- Removable drop in arms to provide flexibility

Pryda Combo Jig

Recognising the historic issues and concerns with traditional manual jig systems, Pryda has developed the new Combo Jig. This system incorporates the integrity of the multi-station jig positioning along with the flexibility of the multi-arm jig profiling.

The jig is designed so that the truss critical points (i.e. heels and apex) and bottom chord locations are fixed by pressing stations, with all other referenced by movable arms. All arms are quickly interchangeable. The arms provide the flexibility required when producing complex roof shapes where pressing stations may clash.

Complex or difficult trusses such as scissor profile can be accurately jugged by using the systems upper and lower pressing stations.

The low profile rails allow operators to move through and around the jig, without sacrificing truss accuracy and ensuring the easiest possible materials handling.

SPECIFICATIONS

			Dimensions
Overall dimensions (std unit)	– width	mm	16750
	– height	mm	4085
Maximum truss size produced		m	16 x 4.0
Working height (approx)		mm	800
Apex & base beam height (approx)		mm	100
Apex stations			2
Heel stations			2
Bottom chord stations			4
Arm lengths	- 3000mm		2
	- 2500mm		2
	-2000mm		2
	-1500mm		2
	-1000mm		2
Air manifolds			Full length along bottom chord & apex rails
Weight (approx)	kg		1420

Installation requirements

Air Connection to manifold at jig mid point

RELATED EQUIPMENT

- air locking of components on station boxes
- moveable apex rail
- extendable bottom chord and apex rail
- can be integrated for use with Pryda's range of bottom chord presses
- additional pressing stations or top chord rails
- truss lifters
- can be used with portal, overhead or hybrid gantry presses
- can be used in conjunction with Pryda's integrated materials handling system